

Salem and Salem Village in 1692. Drawing by the author.

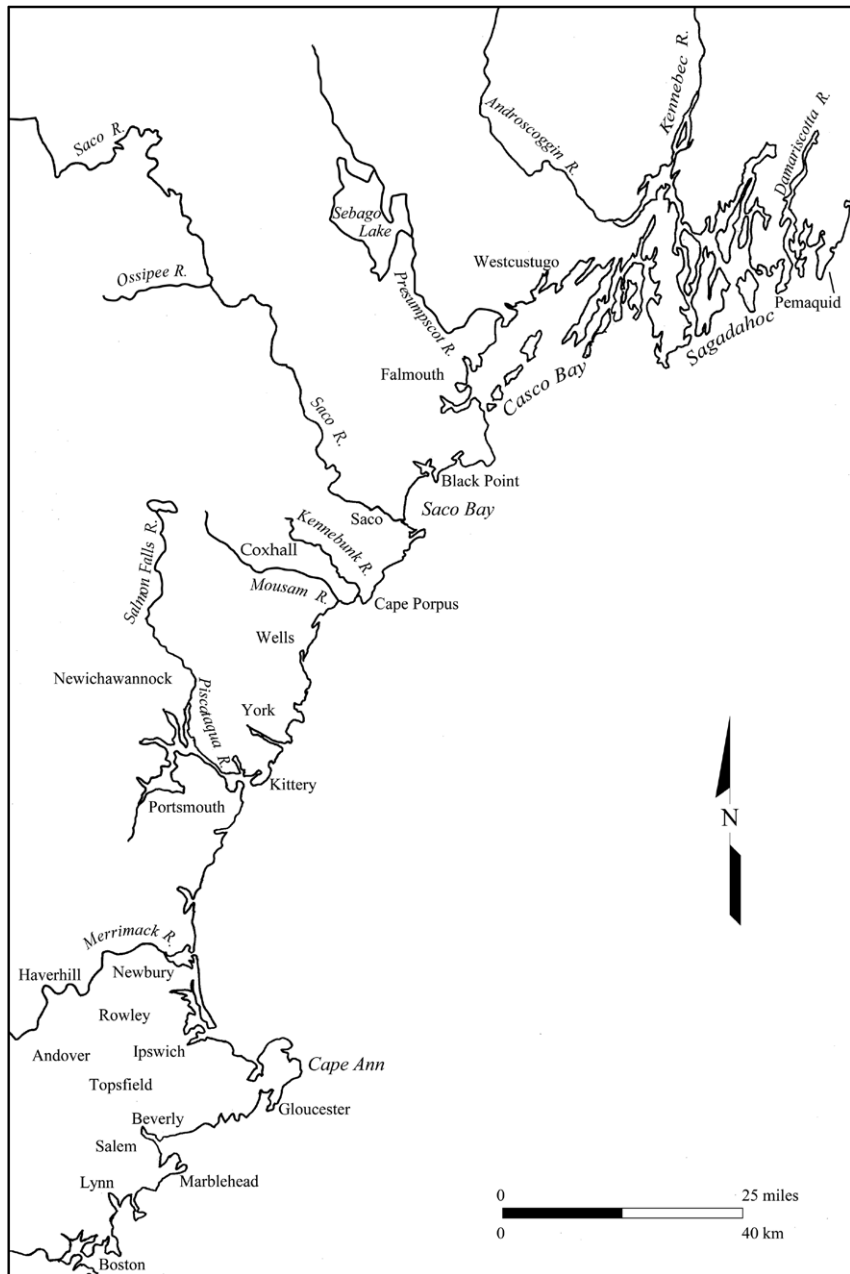

Coastal New England from Boston to Pemaquid in the seventeenth century. Drawing by the author.

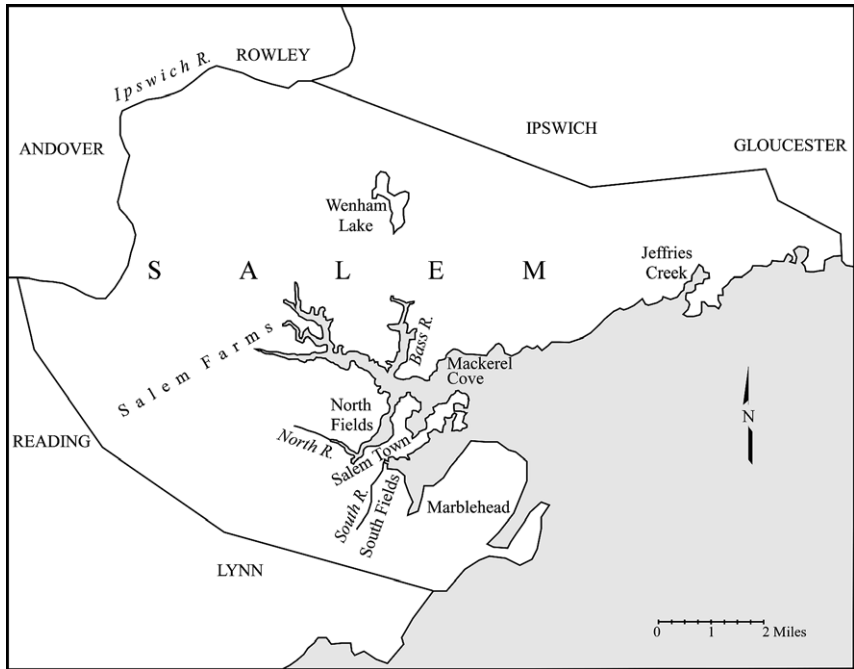

Map of Salem in the early 1640s. Drawing by the author.

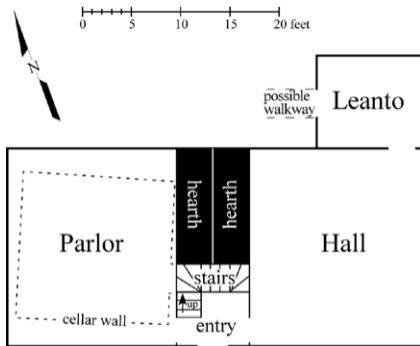

Plan of the Salem Village parsonage in 1692. This conjectural reconstruction of the first floor (and the cellar underneath it) is based the documentary record as well as the 1970 excavation of the site. Drawing by the author.⁴⁵

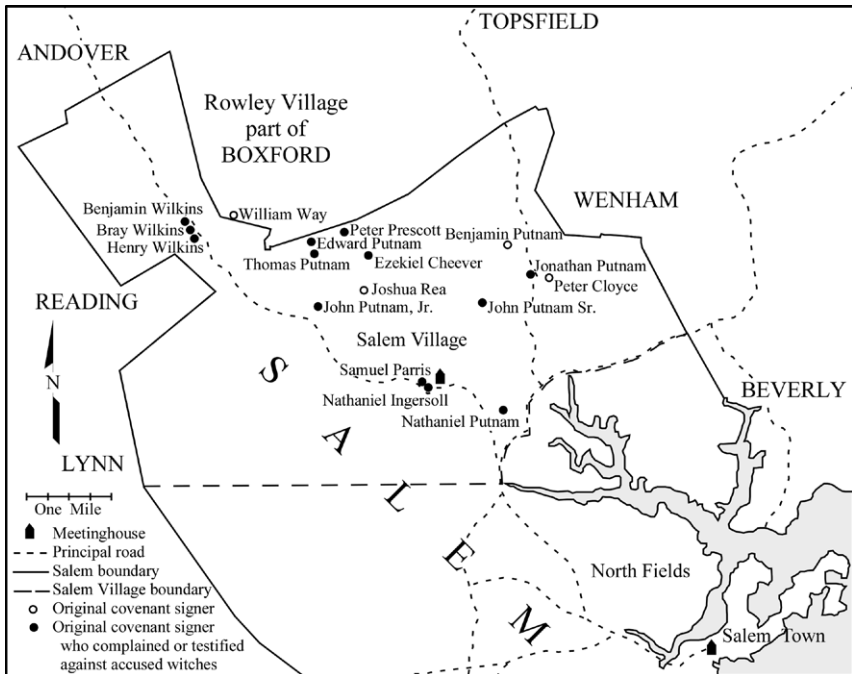

Map of Salem Village with original covenant signers. Drawing by the author.

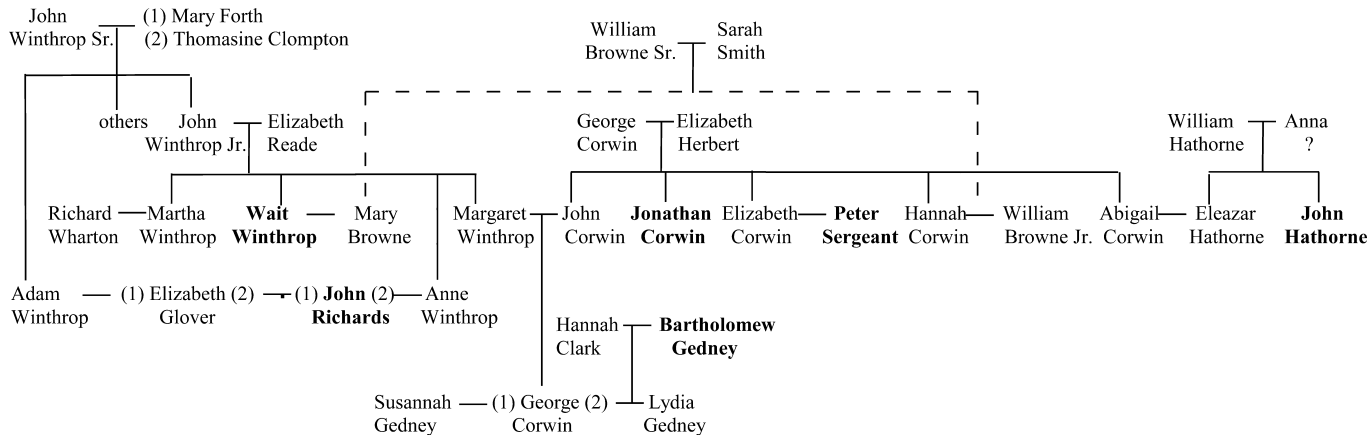

Family connections between the judges of the Court of Oyer and Terminer. Judges are in bold.



The world of the judges. Drawing by the author.

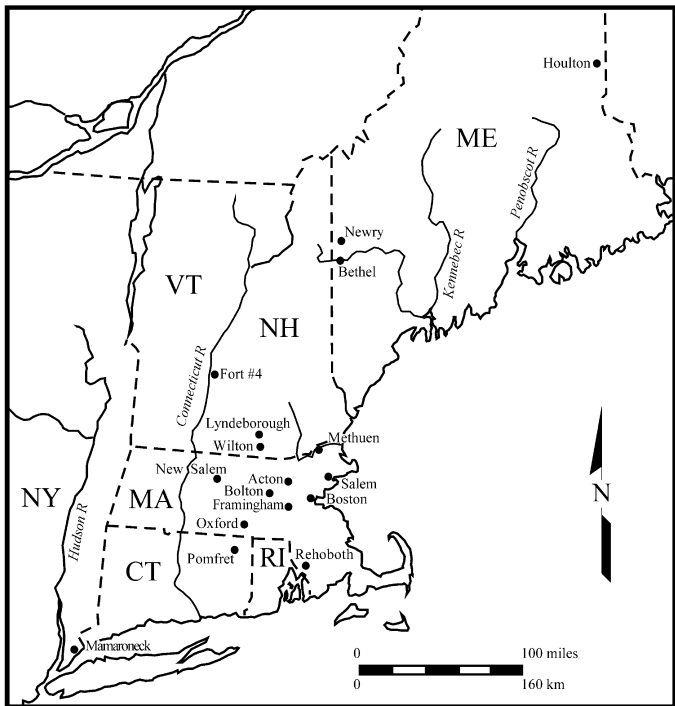

Map of New England, showing the Salem diaspora. Drawing by the author.